

BASEMENT MAP

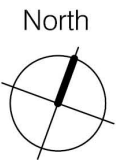

CLINICAL AREAS

- | | | |
|---------------------------------|------------------------|-----------------------|
| ① Social Work/ VIST Coordinator | ⑦ Rehab Medicine/ Pool | ⑬ Nutrition Classroom |
| ② FES/APT Center | ⑧ Prosthetics | ⑭ Spinal Cord Injury |
| ③ Nuclear Medicine / PET Echo | ⑨ Radiation Therapy | ⑮ Lab Service |
| ④ Ocular Motility | ⑩ Radiology | ⑯ Morgue |
| ⑤ Pharmacy - Inpatient | ⑪ Mental Health | |
| ⑥ Pharmacy - Outpatient | ⑫ Ultrasound / CT | |

PUBLIC RESTROOM



CLOSED CORRIDOR

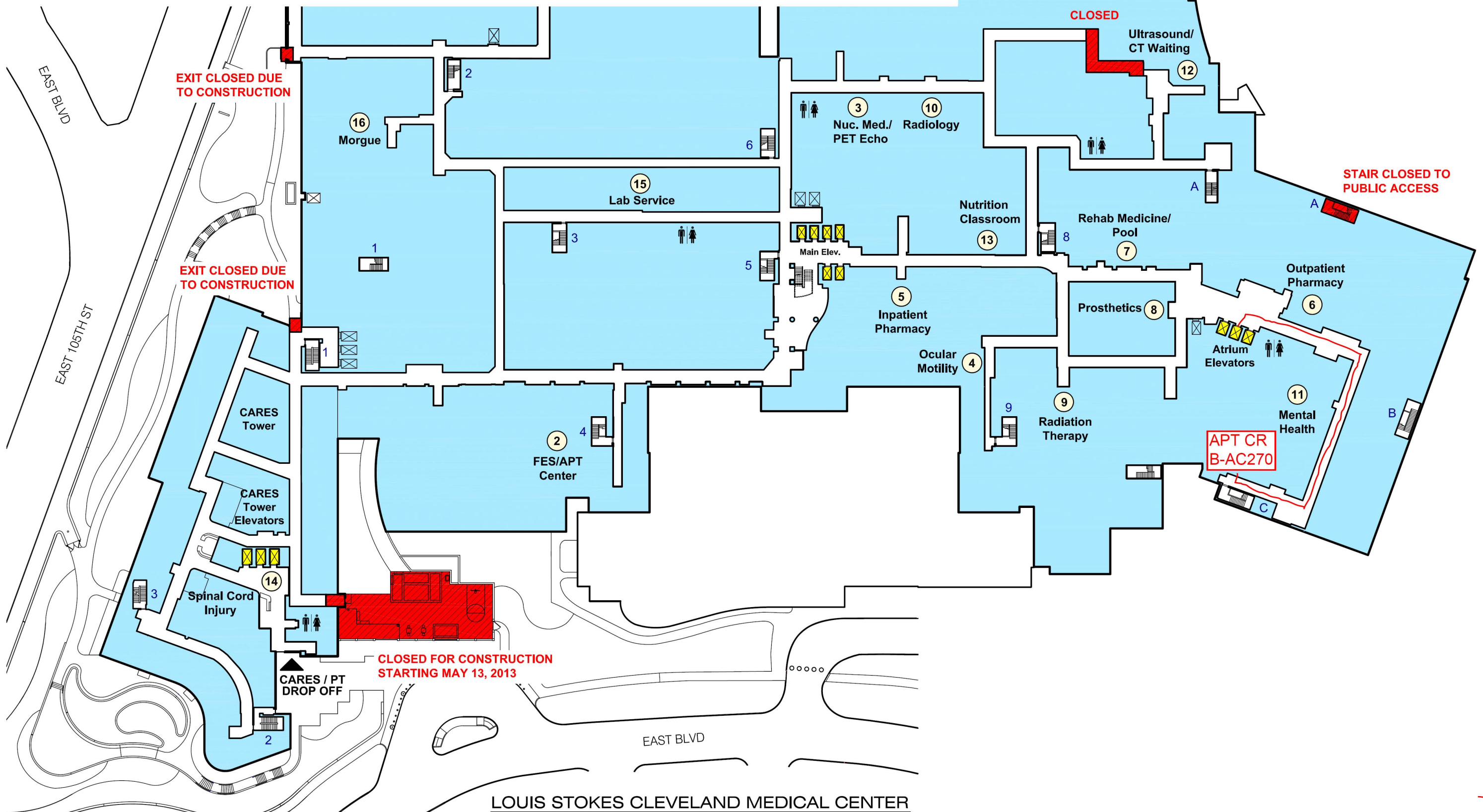

LOUIS STOKES CLEVELAND MEDICAL CENTER